

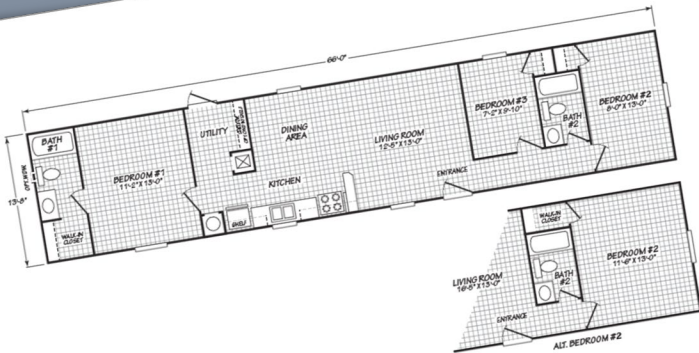

Economy Series – 14663Z

FLEETWOOD HOMES
ROCKY MOUNT, VA





Economy Series

Meets Extraordinary Value

Value
Driven

Quality
Built



Architectural Shingles

Vinyl Shutters on Front Door Side and Hitch End

Built to Energy Star Envelope

2 x 6 Exterior Walls

R40-21-33 Insulation

8' Flat Ceilings Throughout

40 Gallon Water Heater

Water Shutoffs at all Sinks and Commodes

Fiberglass Tub/Shower Units

LED Recessed Lighting

Ceramic Backsplash at all Countertops

38" x 82" Steel Front Doors

Full View Glass From Storm Doors

ECONOMY

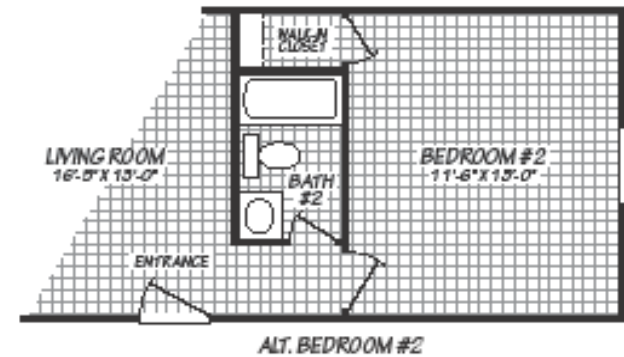
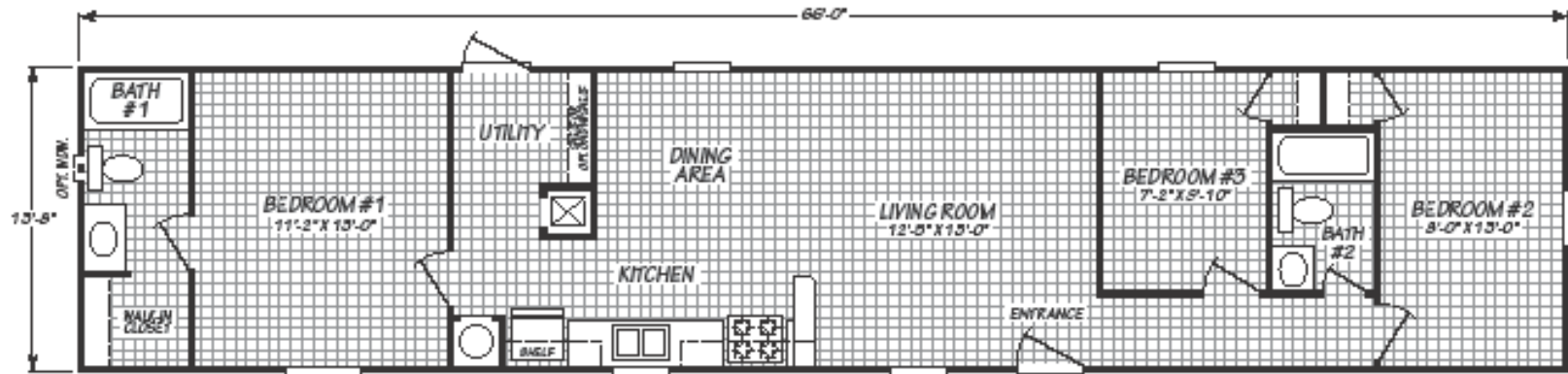

MODEL 14663Z

3 Bedroom • 2 Bath • 902 Square Feet

©2023 FLEETWOOD HOMES INC. ALL RIGHTS RESERVED

Important: Because we continually update and modify our products, it is important for you to know that our brochures are illustrative and for illustrative purposes only. ILLUSTRATIONS MAY SHOW OPTIONAL FEATURES. All information contained herein may vary from the actual home we build. Dimensions are nominal length and width measurements are from exterior wall to exterior wall. We reserve the right to make changes at any time, without notice or obligation, in prices, colors, materials, specifications, features and models. Please check with your retailer for specific information about the home you select.





Living Room and Dining Room,
Designed to Compliment
An Array of Furniture Styles



Vinyl Low E Thermal Windows
provides an abundance of light
while helping with energy
savings.



Linoleum Flooring
Throughout Home



Porcelain Sinks
Fiberglass Tub/Shower
Ceramic Backsplash
In Baths



Economy Series 14663Z Standards

FLOORS/PLUMBING

- Recessed Chassis – 4 Axles
- Removable Hitch
- Energy Star Envelope
- R40-21-33 Insulation
- 40 Gallon Water Heater
- Water Shutoffs at Sinks and Commodes
- 54" Fiberglass Tub/Shower in Master
- 54" Fiberglass Tub/Shower in Guest Bath
- Elongated Raised Height Commodes
- Install Dryer Vent Through Floor

CABINET SHOP

- 42" Kitchen Overhead Cabinets
- Lined Overhead Kitchen Cabinets with 2 Fixed Shelves
- Lined Base Cabinets with Center Shelf
- Black Vented Range Hood
- Shelf Over Refrigerator
- Shelf Over Range
- Post Form Countertops
- 36" Vanity Height All Baths
- 8" Double Bowl Stainless Steel Kitchen Sink
- Square Porcelain Sinks All Baths
- Dual Handle Plastic Nickel Faucets both Baths
- Plastic Chrome Dual Handle Faucet with J-Spout in Kitchen

WALLS

- 8' Flat Ceilings
- 2 x 6 Exterior Walls

ELECTRICAL

- Jelly Jar Style Exterior Lights
- 6" Recessed LED Lights Throughout
- (1) 6" Recessed LED Light Over Master Bath Vanity & (1) 6" Recessed LED Light Over Guest Bath Vanity
- Exterior GFI Receptacle

EXTERIOR

- 12" Overhang on Hitch End
- Hardi-Board Fascia
- Foam Core Backer Board
- 38" x 82" Six Panel Front Door with Composite Jamb
- 34" x 80" Six Panel Steel Rear Door
- Vinyl Low E Thermal Windows
- Shutters on Front Door Side and Hitch End

TRIM

- MDF Shaker Cab Doors with Satin Nickel Hardware and Hidden Hinges
- (1) Row Ceramic Tile in Kitchen and Baths
- White 2 Panel Interior Doors
- Furnace Access Door
- 2.5" Flat Molding at Ceiling
- Lip Casing around All Windows
- Door Casing around All Doors
- 1" Batten - Wall Color - in All Linoleum Areas
- Matching Cabinet Crown on All Overhead Cabinets
- Wire Shelf at Washer/Dryer Area
- 2" Mini Blinds Throughout
- (1) 24" x 32" Mirrors Over All Bath Sinks

FINAL

- Black 18 CF Refrigerator Black Electric Coil Top Range
- Full View Glass Storm Door Shipped Loose with Hardware for Front Door

